

DEAD SPACE: A Burial Alternative for Israel

TLV Metropolitan Burial expectancy
5 Milion burial Spaces | **20 km²**

Israel Faces a severe burial space chisis: a forecast of 10 million deceased (5 milllion in TLV metropolitan area) during the next 100 years. Its current attempts at burial densification fail both numerically and in the quality of the space they produce.

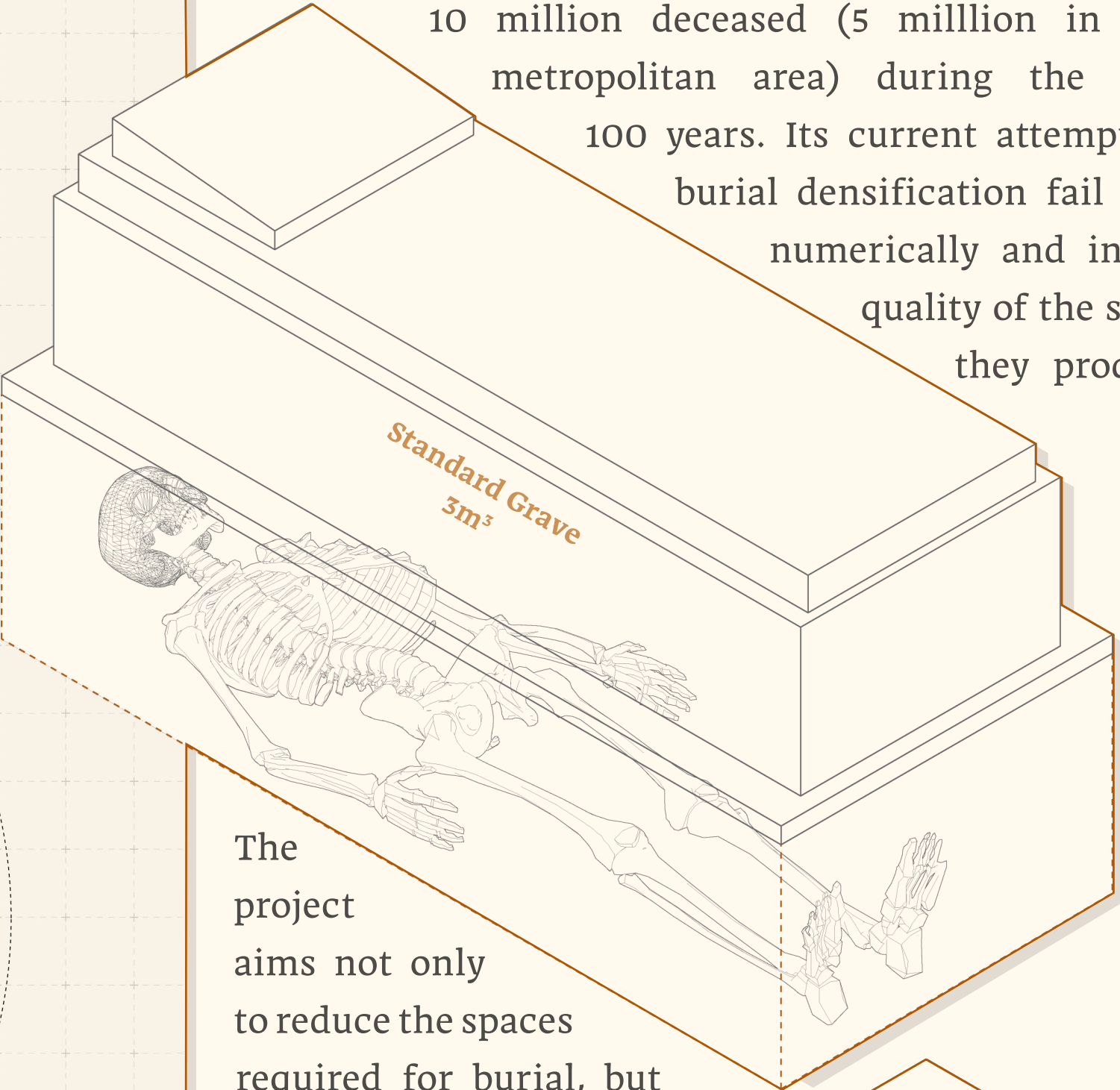

The project aims not only to reduce the spaces required for burial, but also to improve their spatial and ceremonial qualities. While proposing an applicable solution to Israel's burial space chrisis, the project focuses on utilizing burial as an opportunity to create unique public spaces that are integrated into the urban environment and daily life.

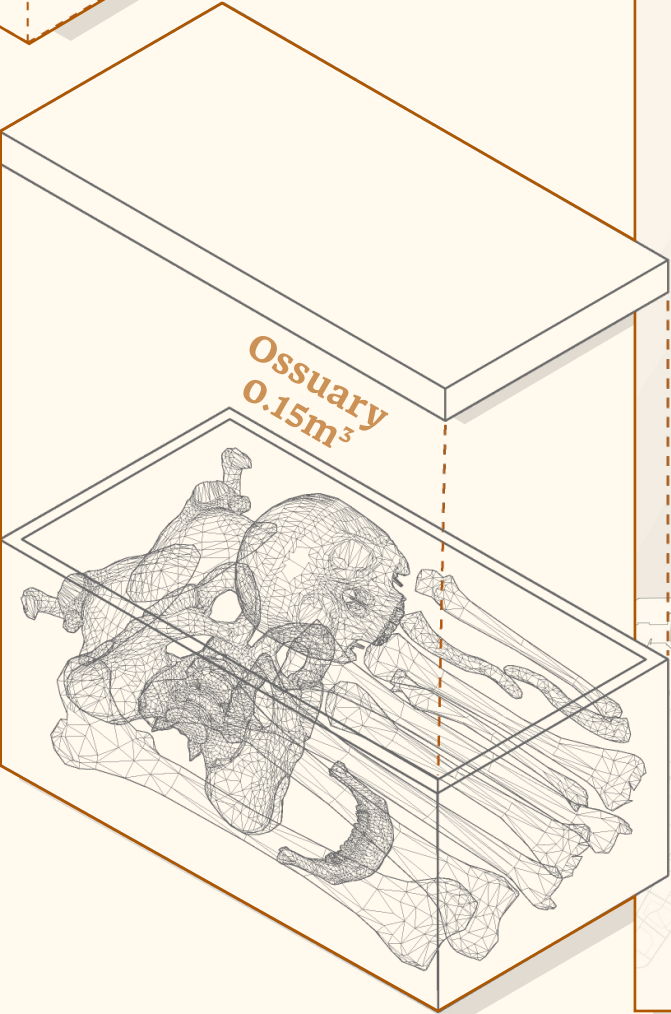

New Regional Plan
5 Milion burial Spaces | **1.3 km²**

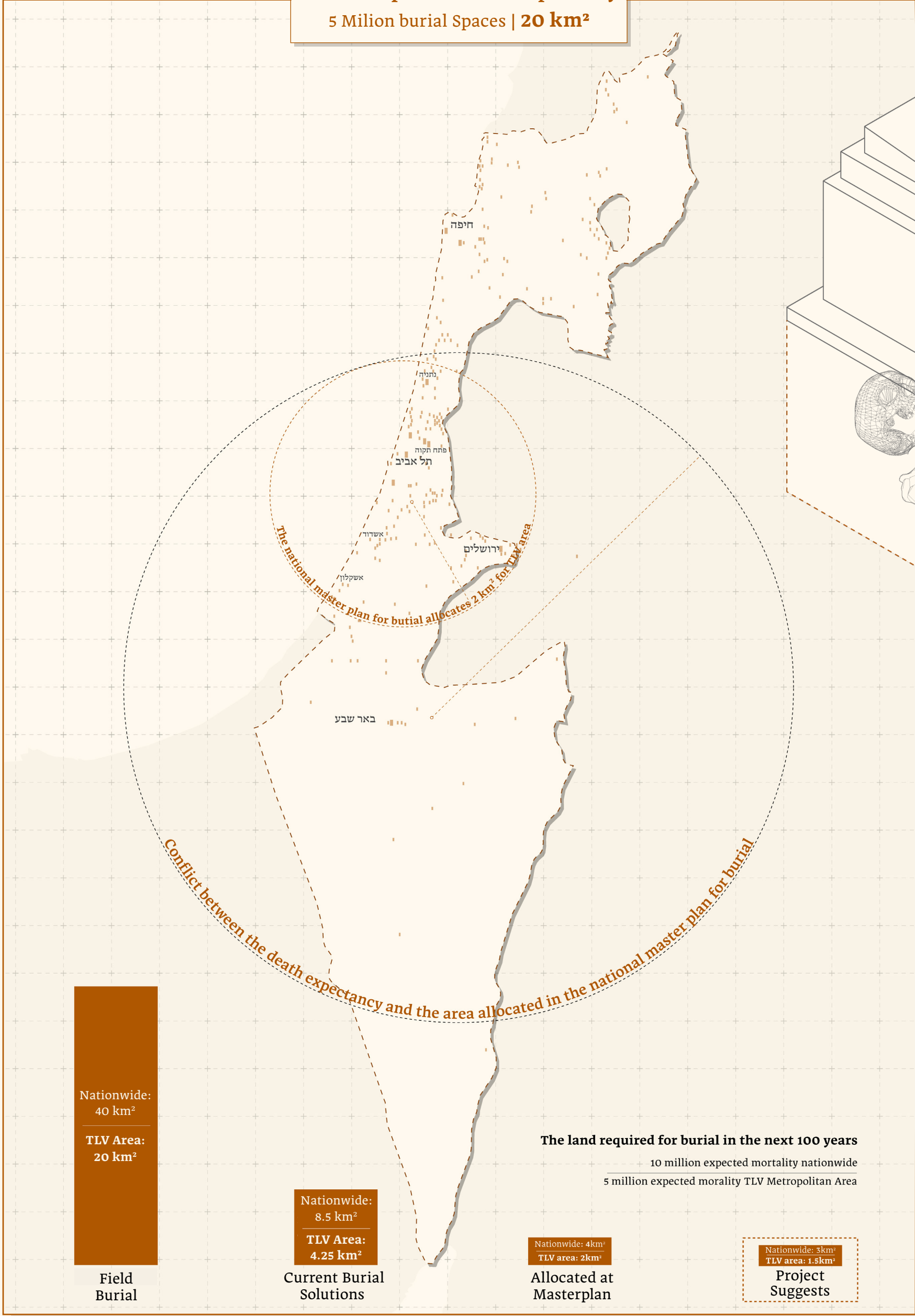
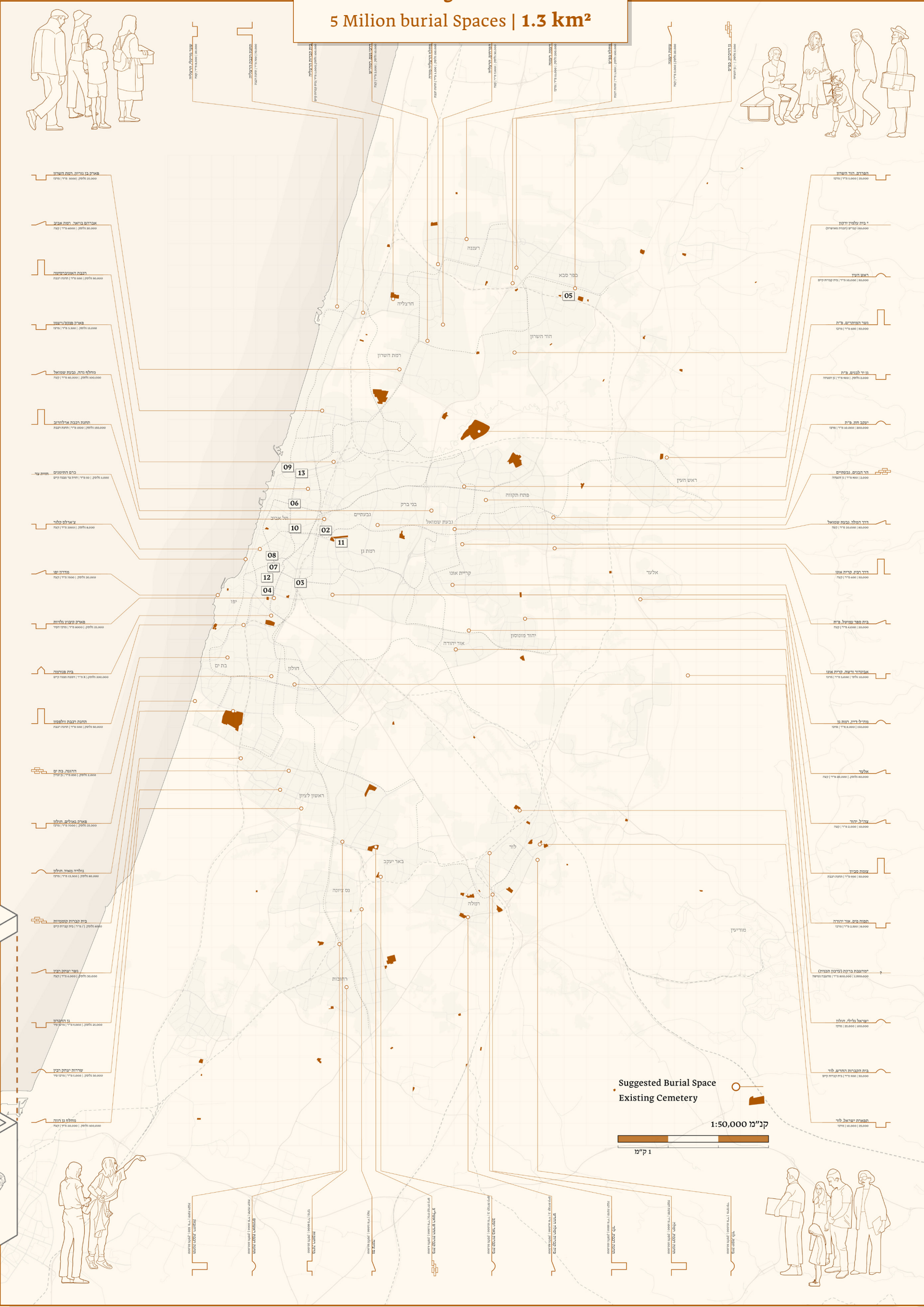

A New Burial Unit: The Ossuary

The project offers to bring back the use of an ancient Jewish burial practice: **the Ossuary**, and a two-stage burial process – updating them to present needs. The ossuary is a compact chest, which was widely used in ancient Jewish tradition, made to serve as the final resting place of human bones.

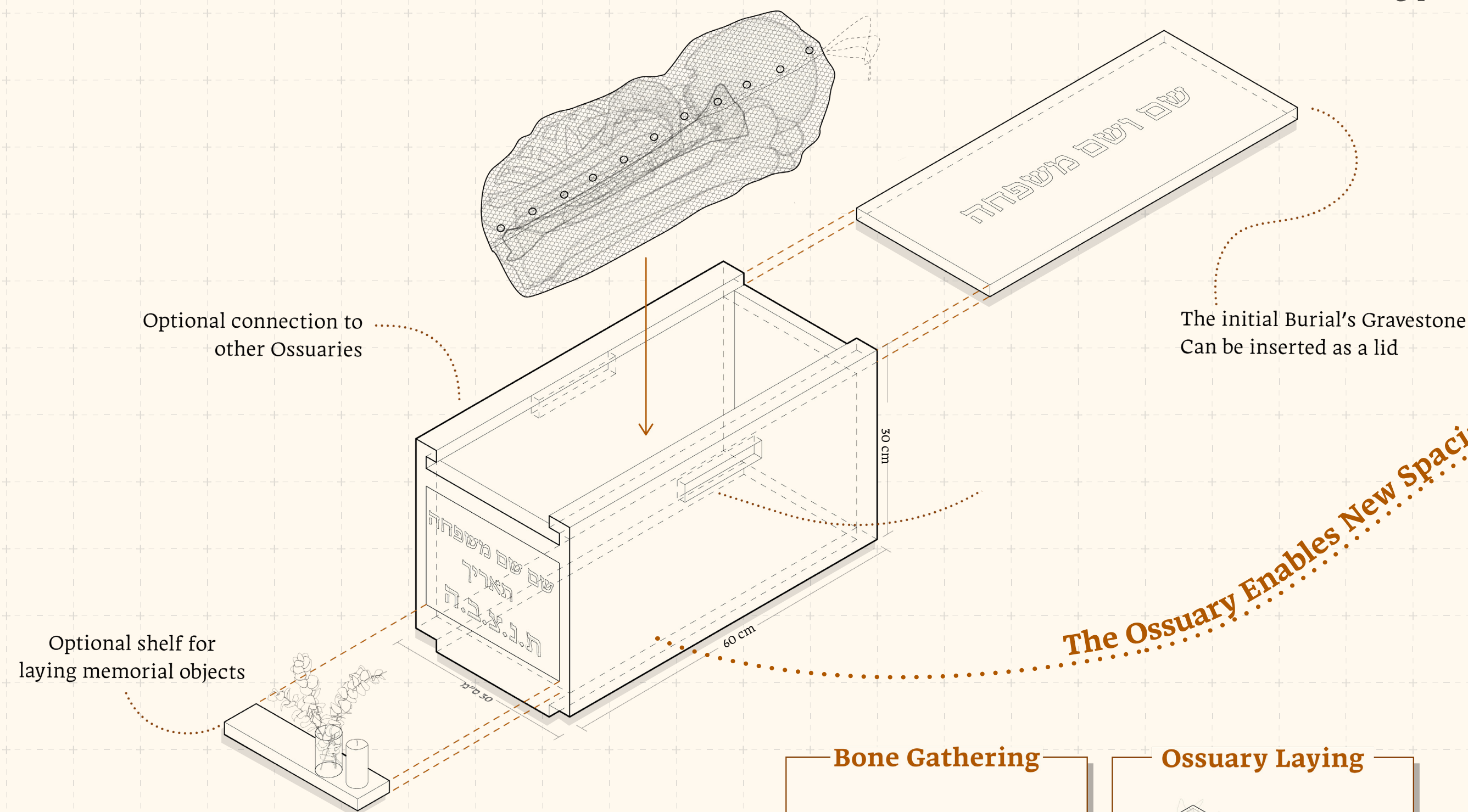

Can be inserted as a lid

The Ossuary Enables New Spatial Possibilities

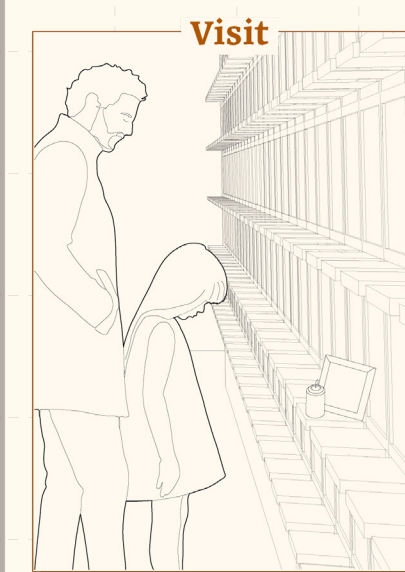
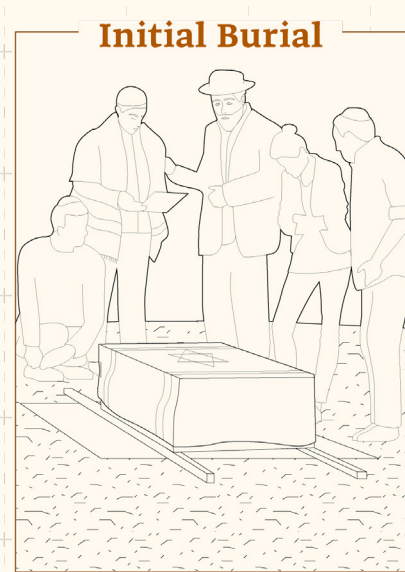
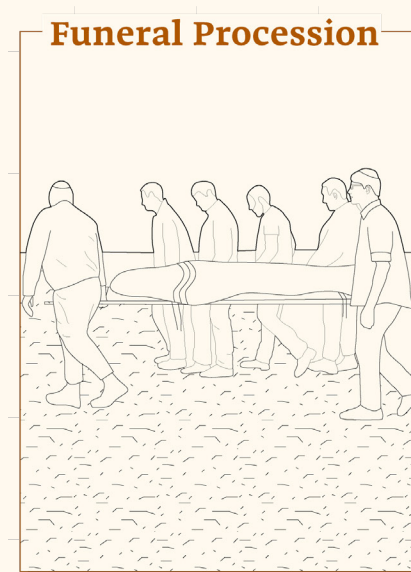
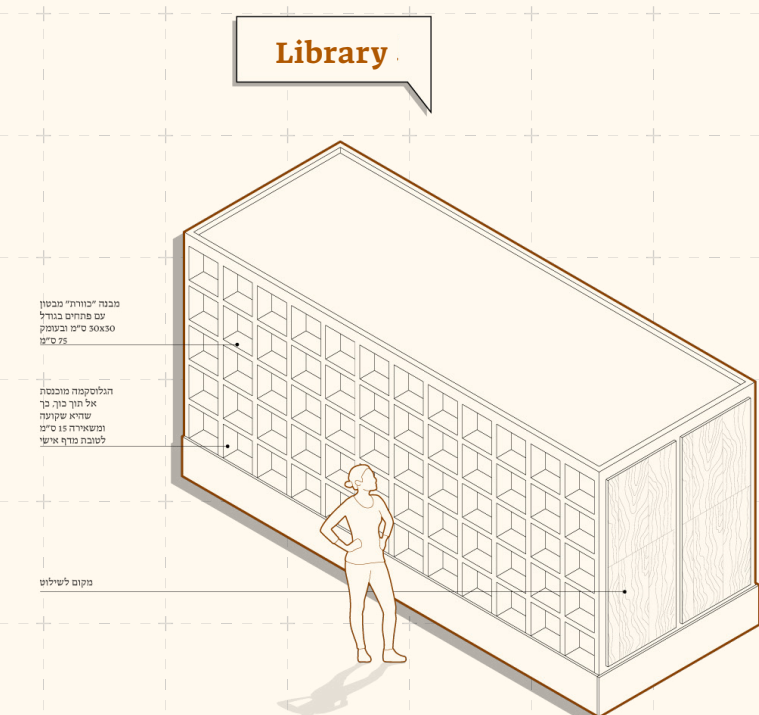
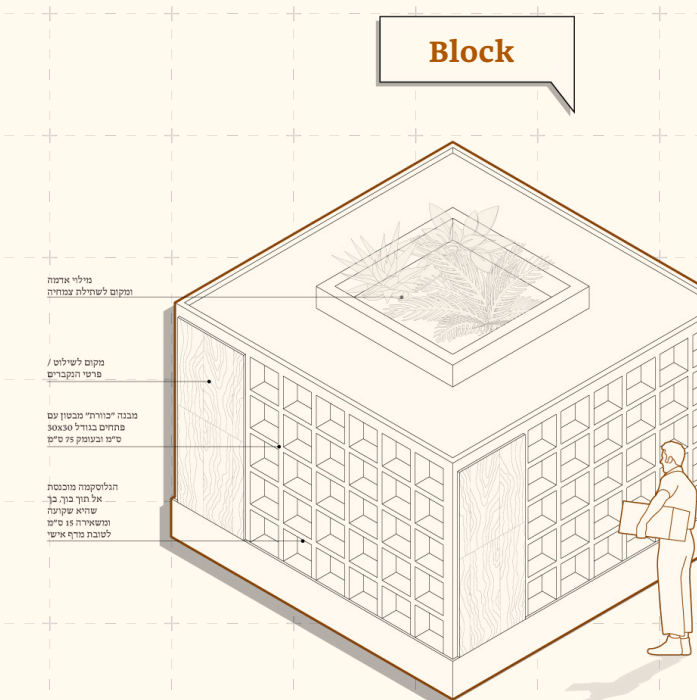
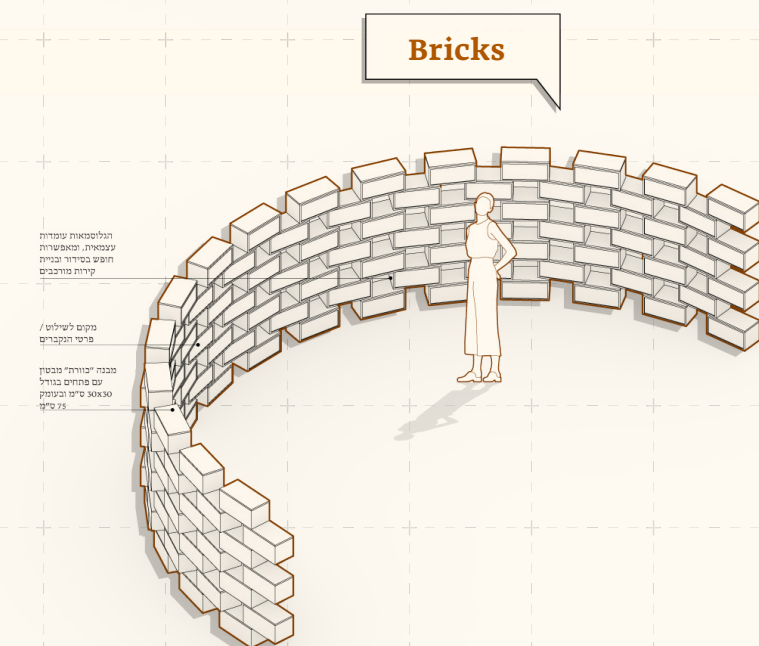
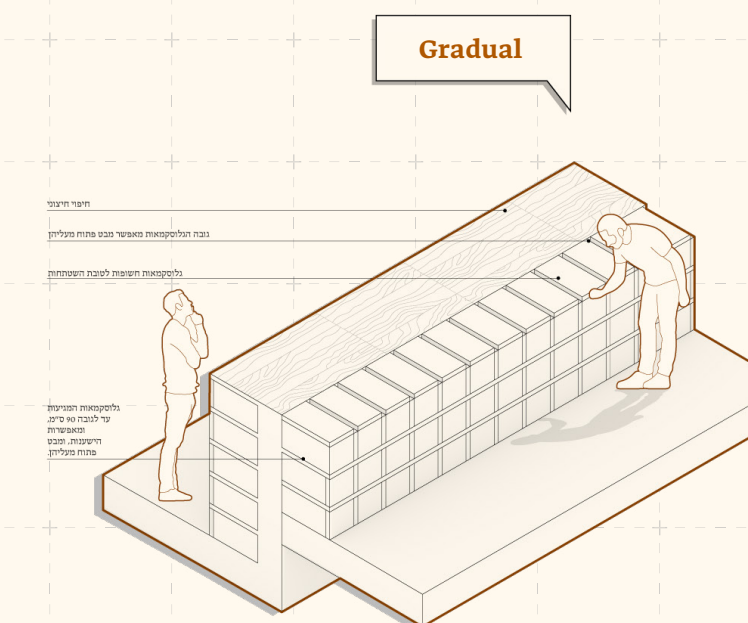
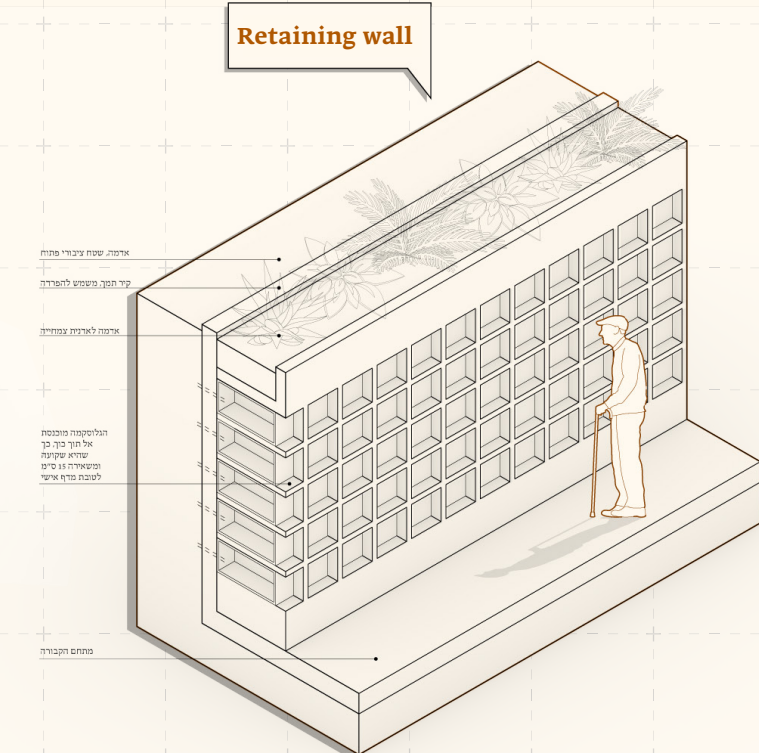

Initial Temporary Burial

Secondary Permanent Burial

Similar to current burial | at temporary burial space

After 1 year | at permanent burial space

New Burial Typologies: Urban Landscapes

The project presents a range of cemetery typologies in order to provide the solution in a diverse and complex manner, which suits different users and a variety of spatial situations.

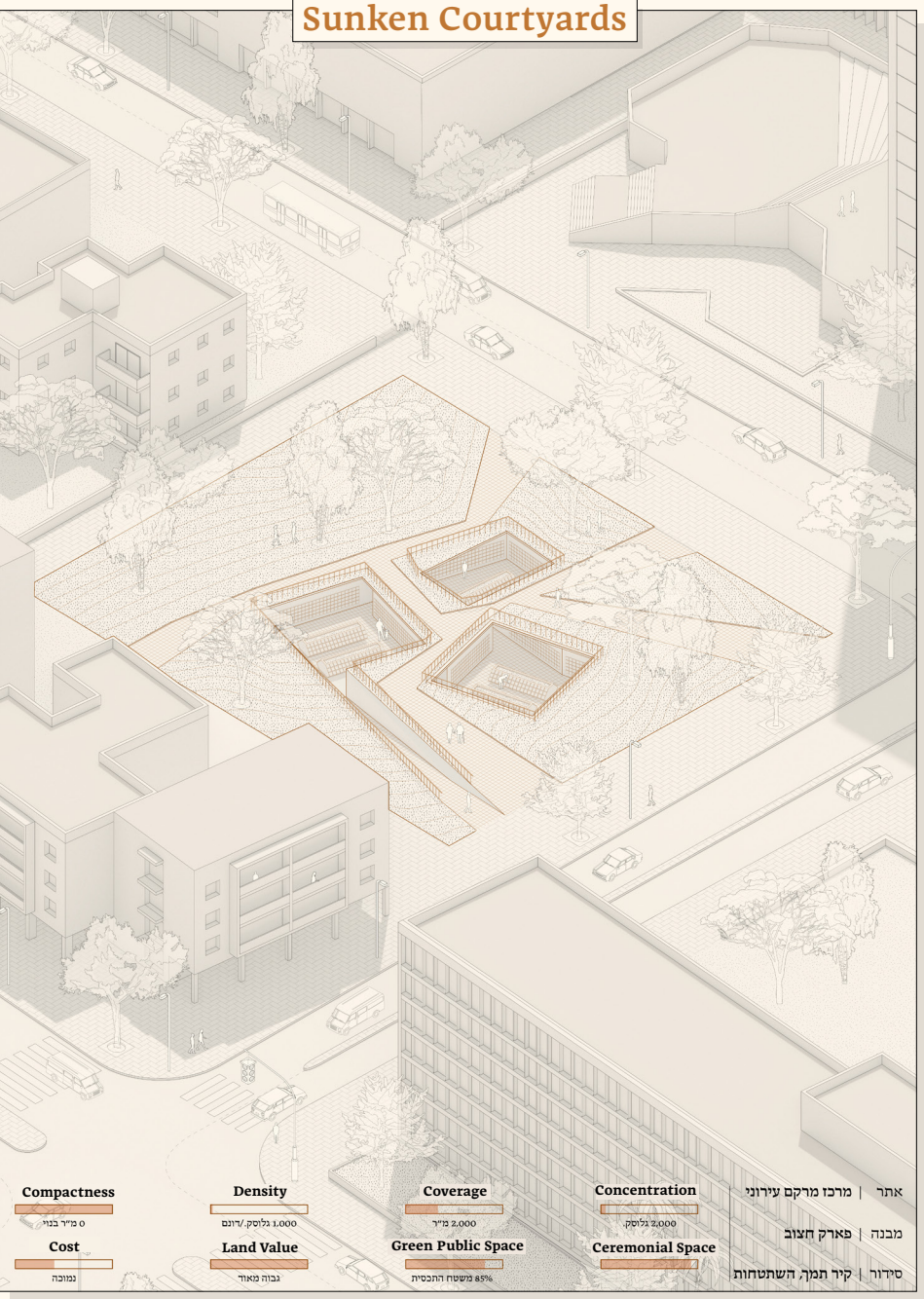
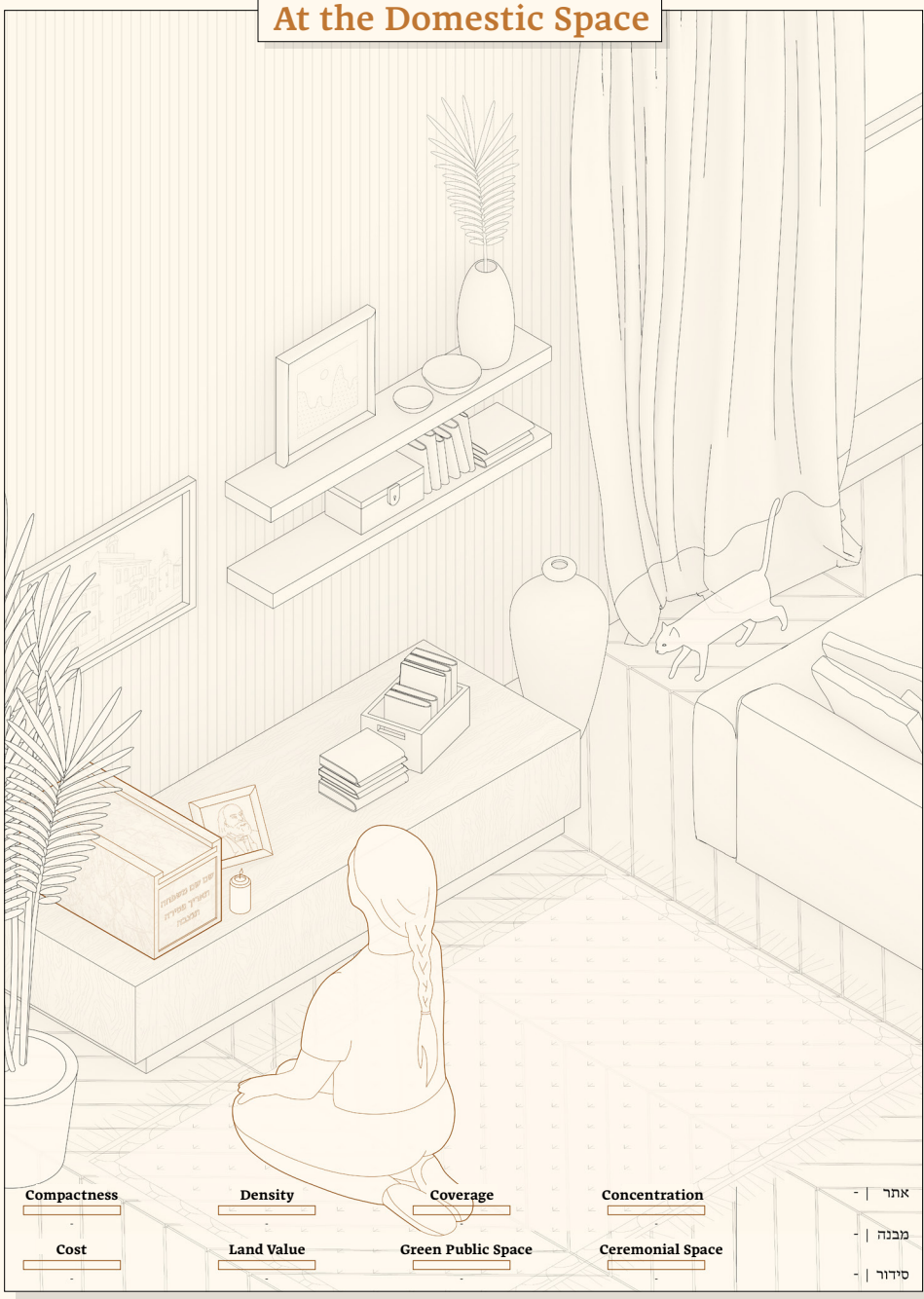
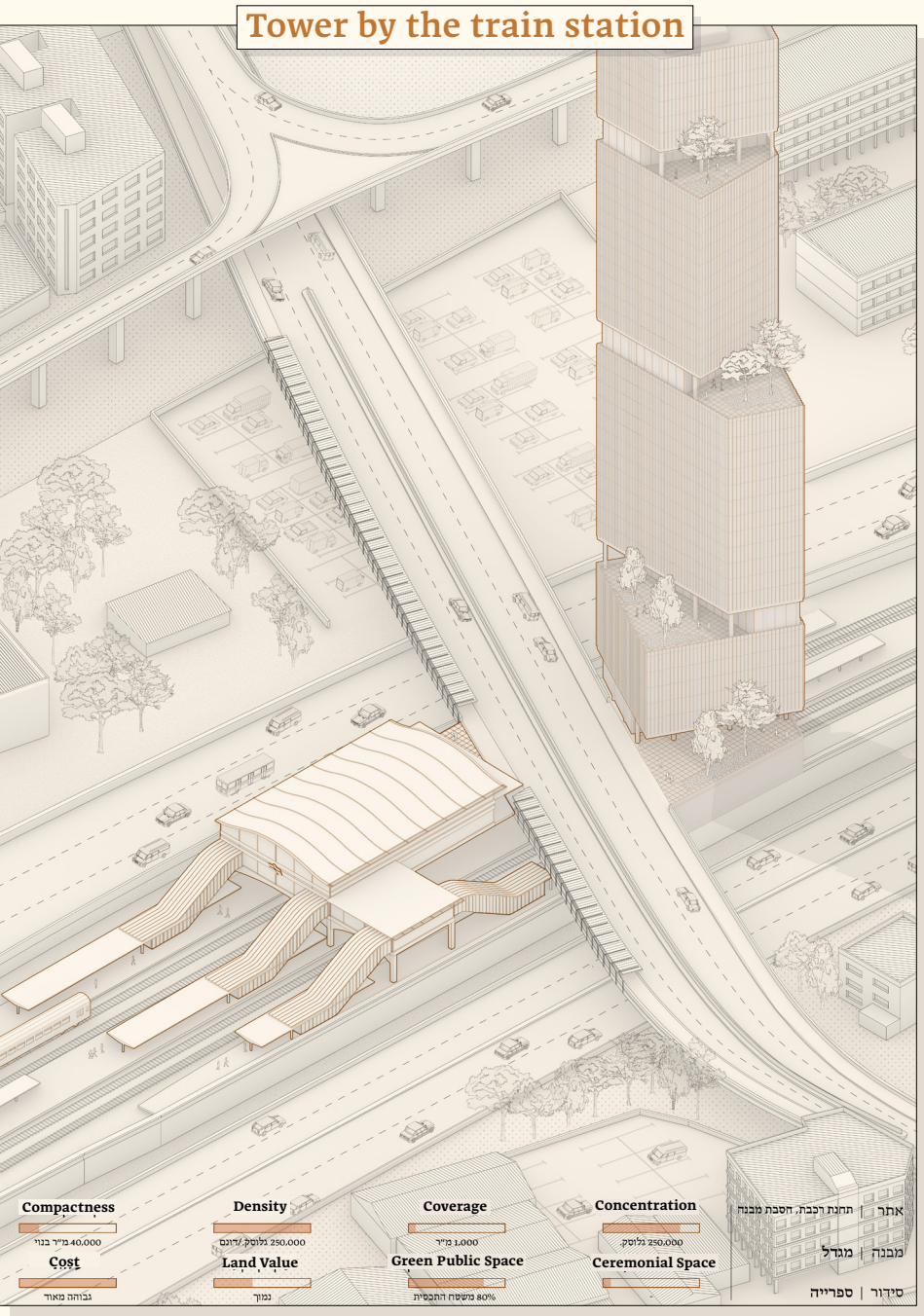
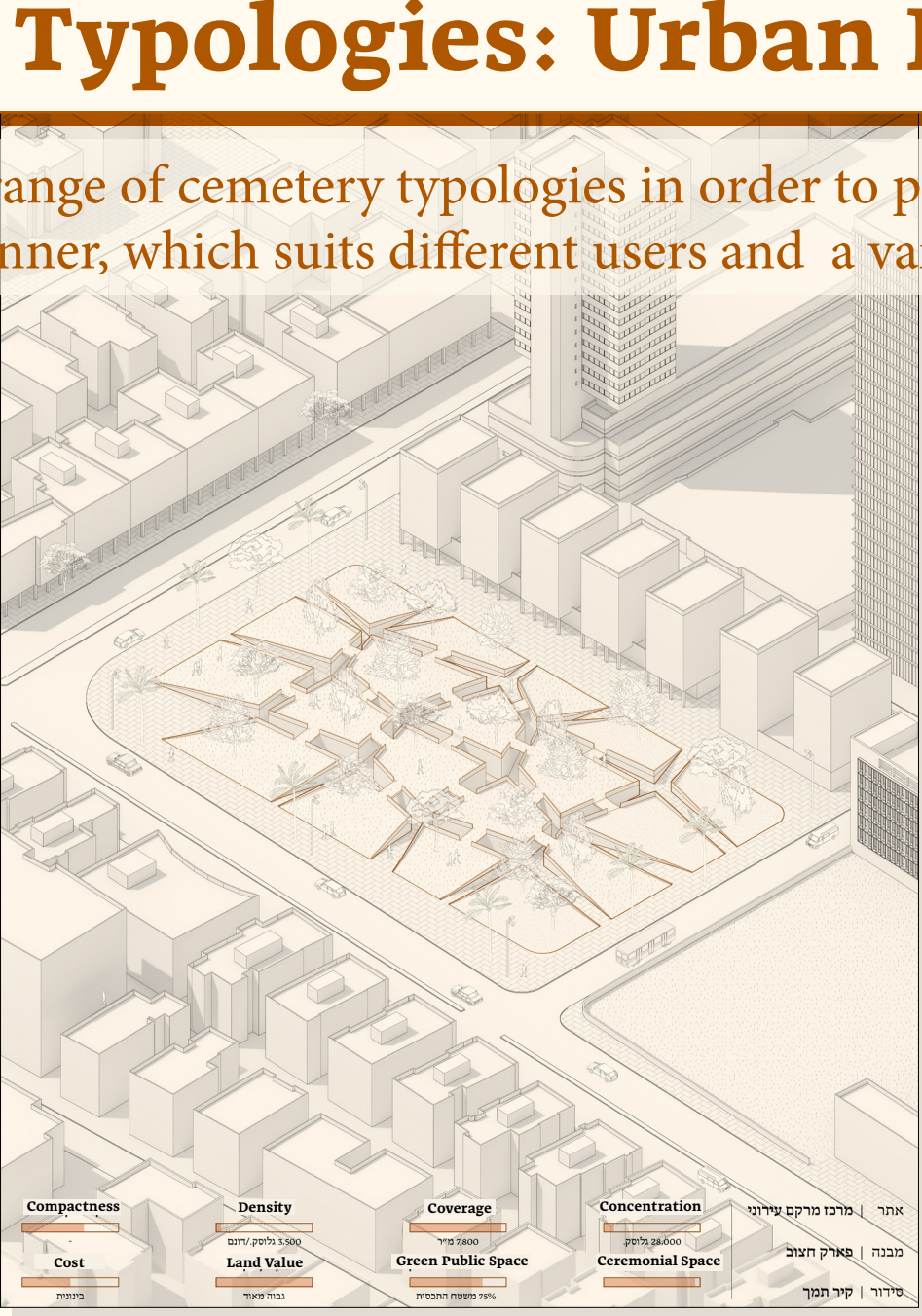
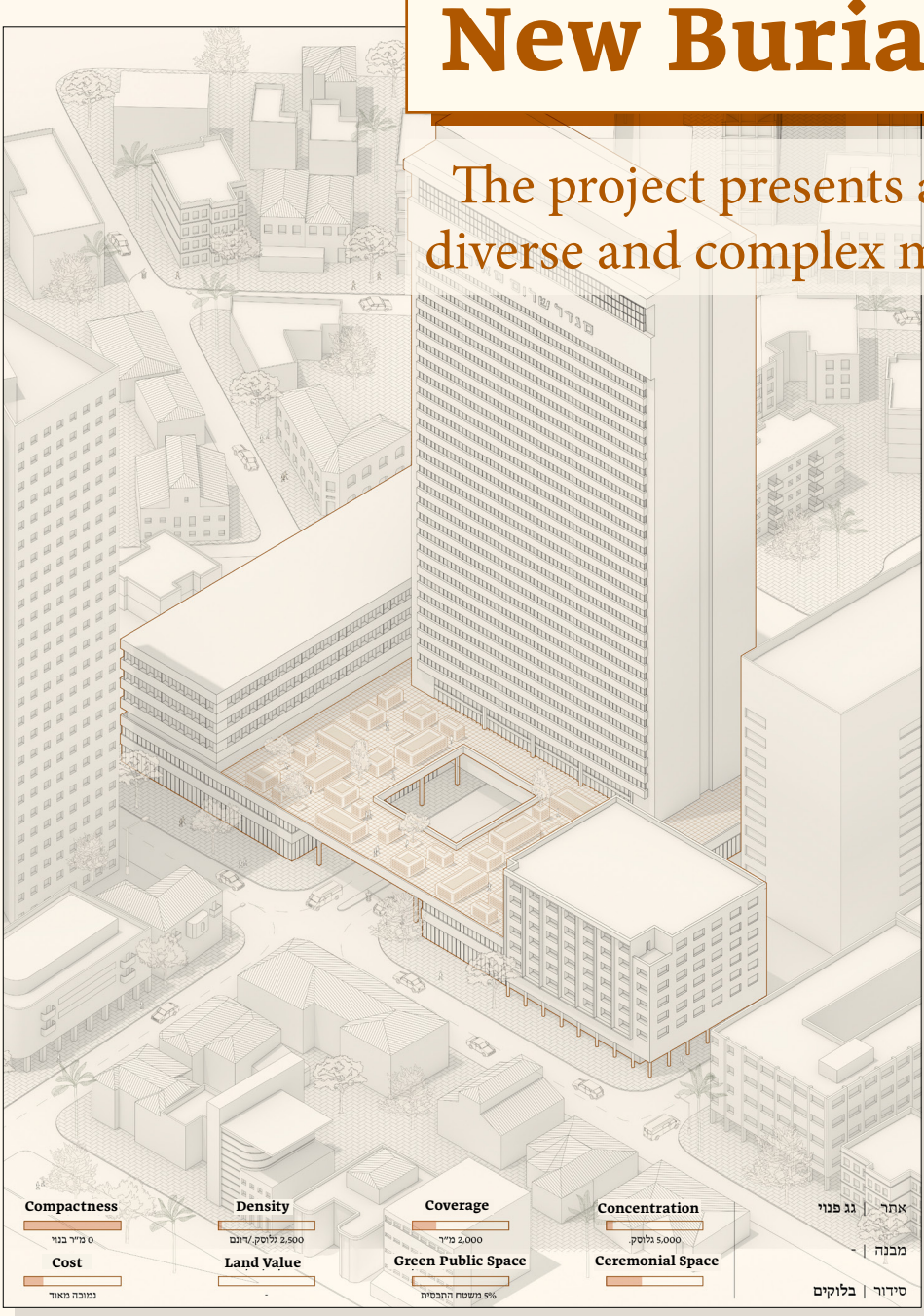
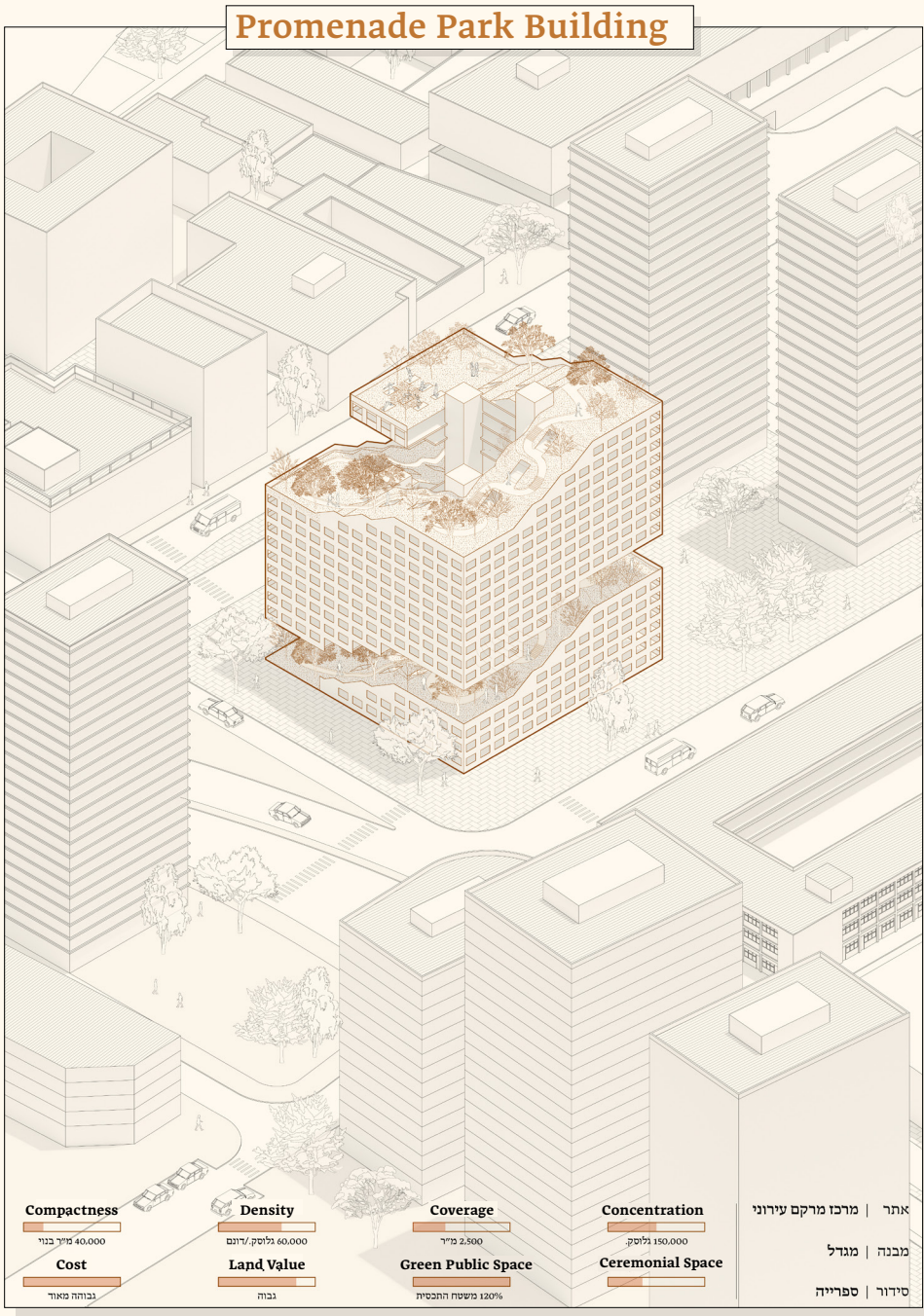

New Burial Space : Urban Burial Garden

A permanent burial space situated as an urban block infill in Tel aviv; demonstrates the integration of burial spaces as part of the everyday urban life, by combining the burial space with a public garden.

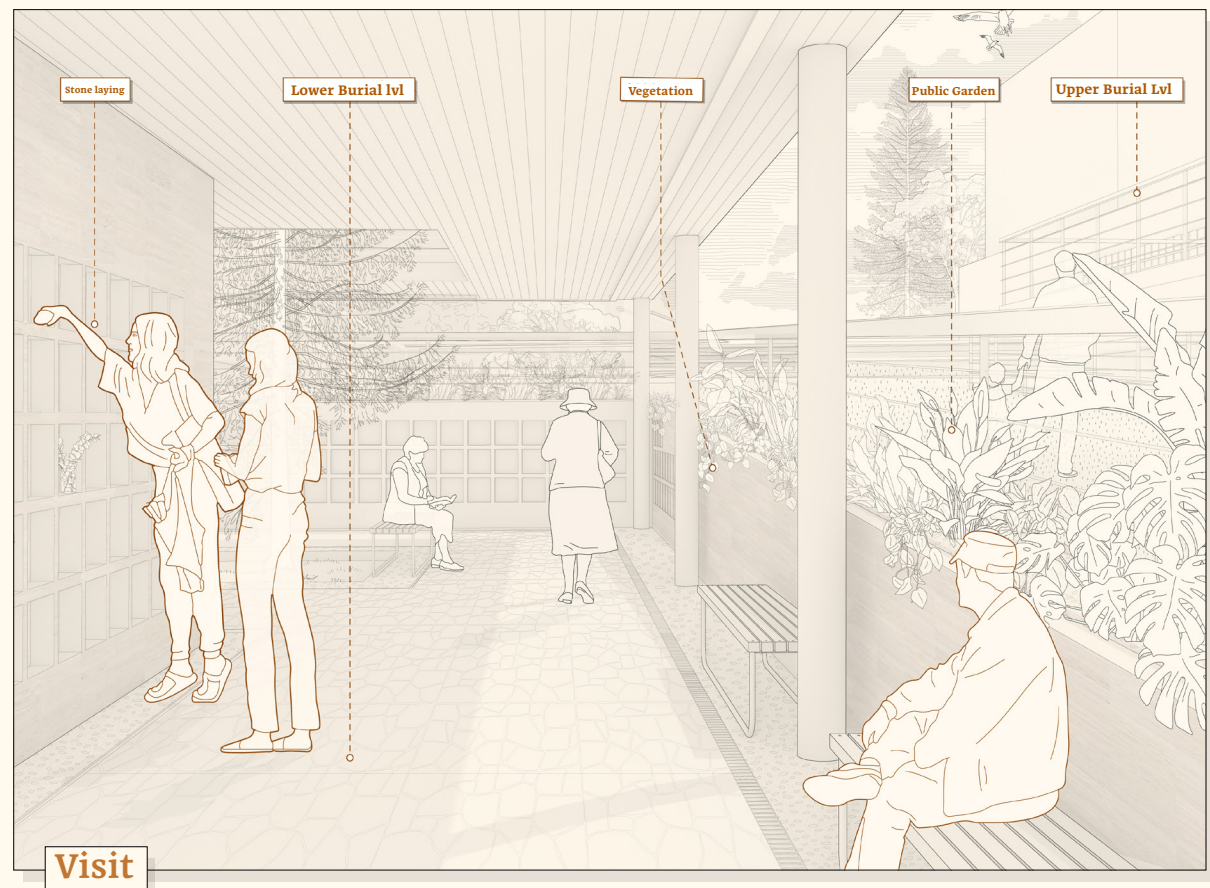
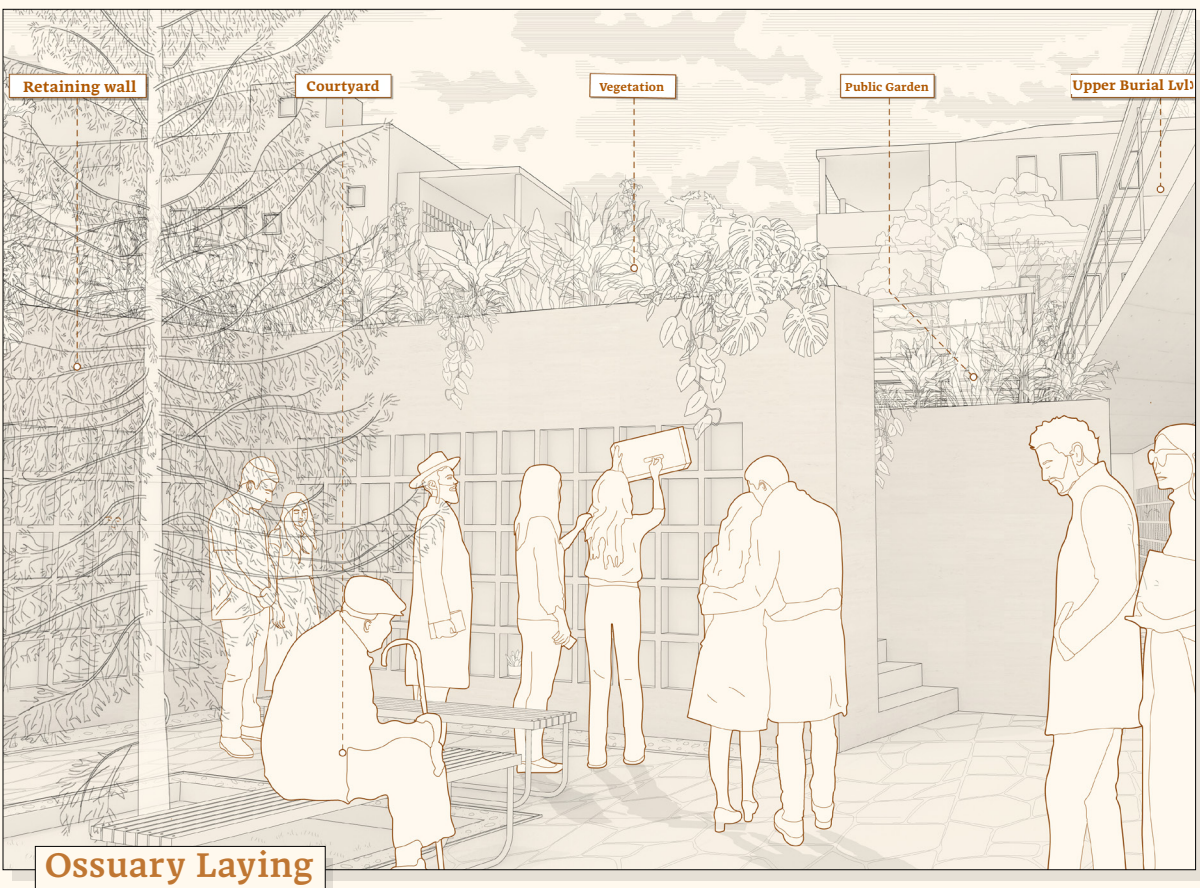
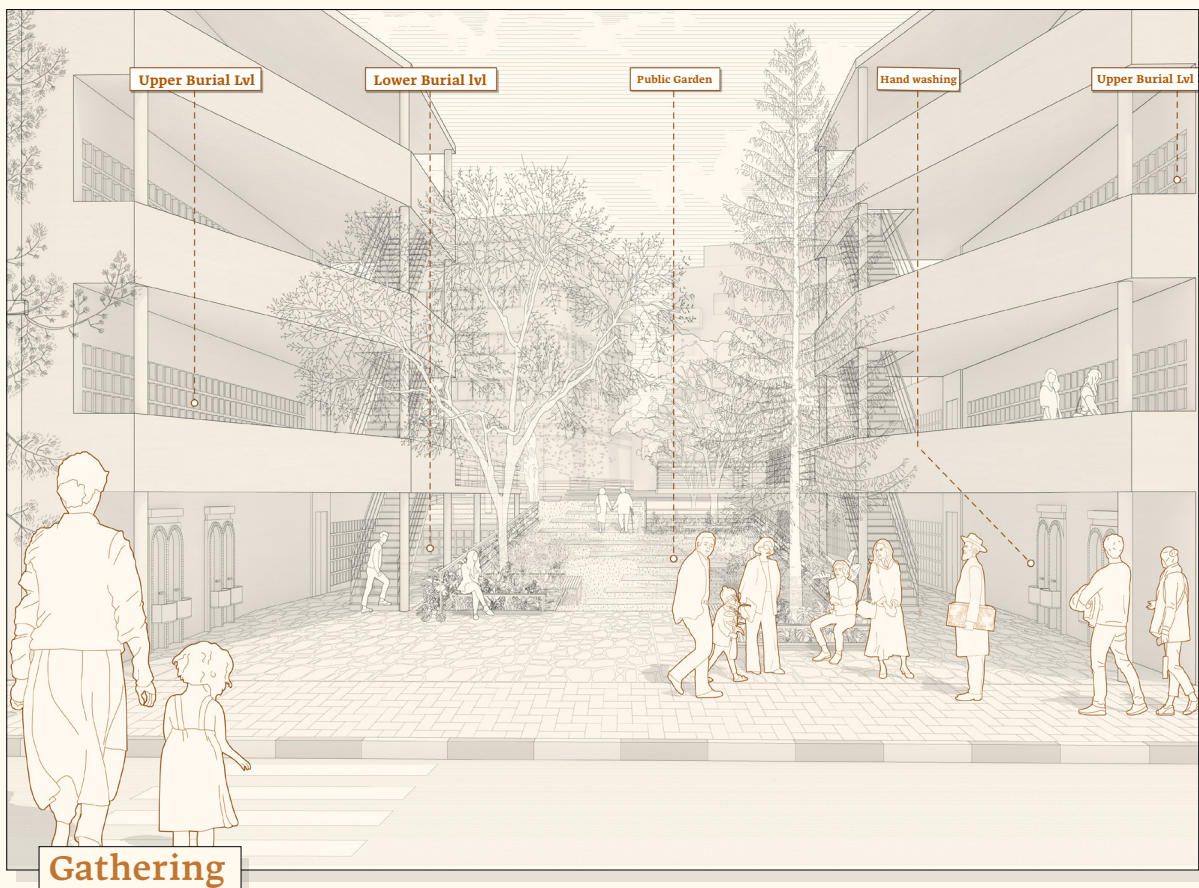
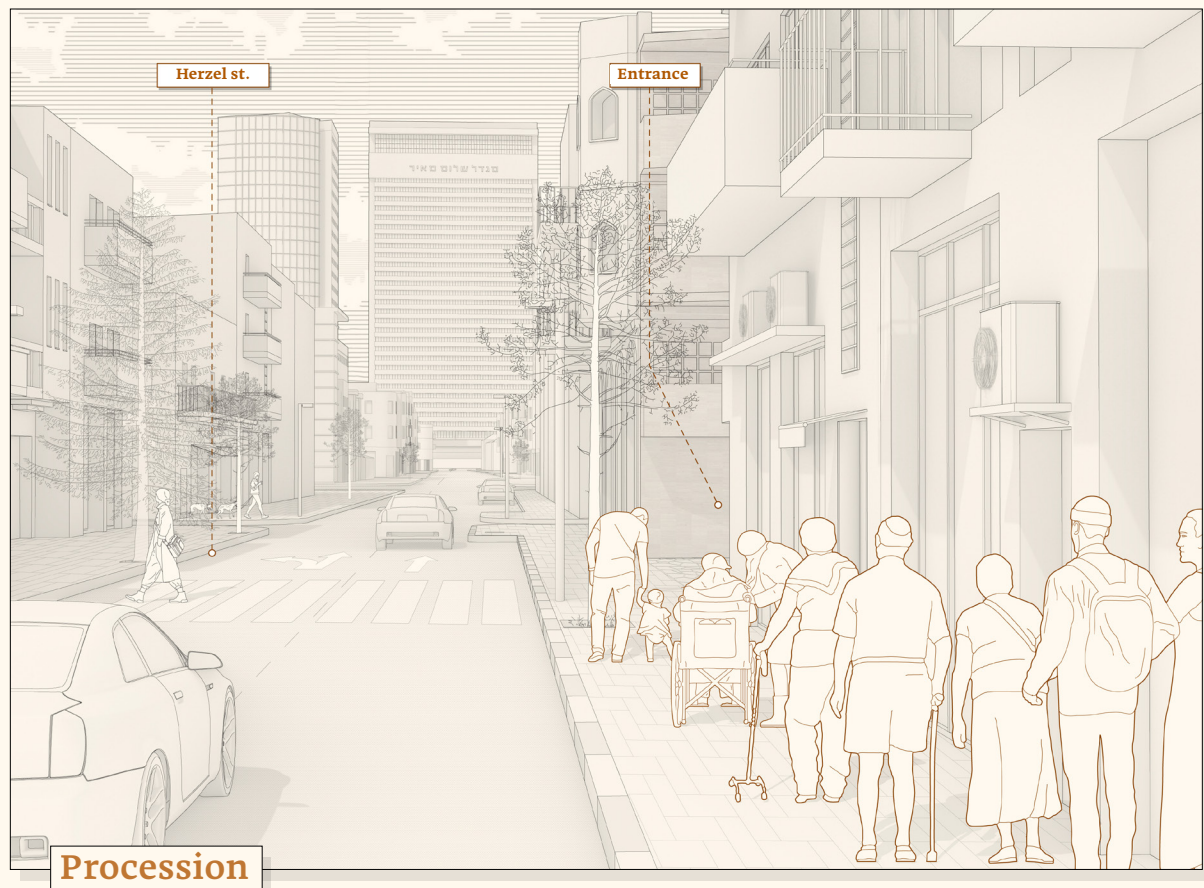
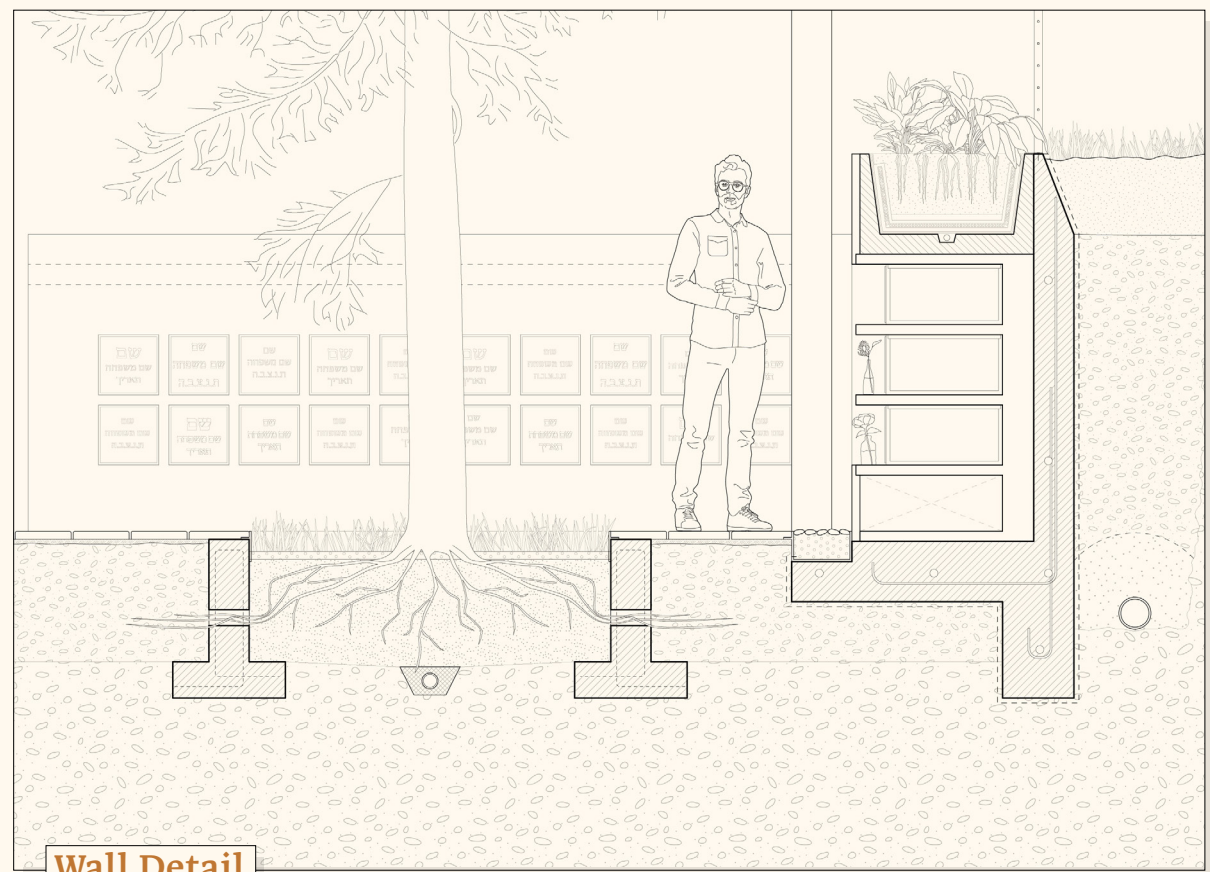
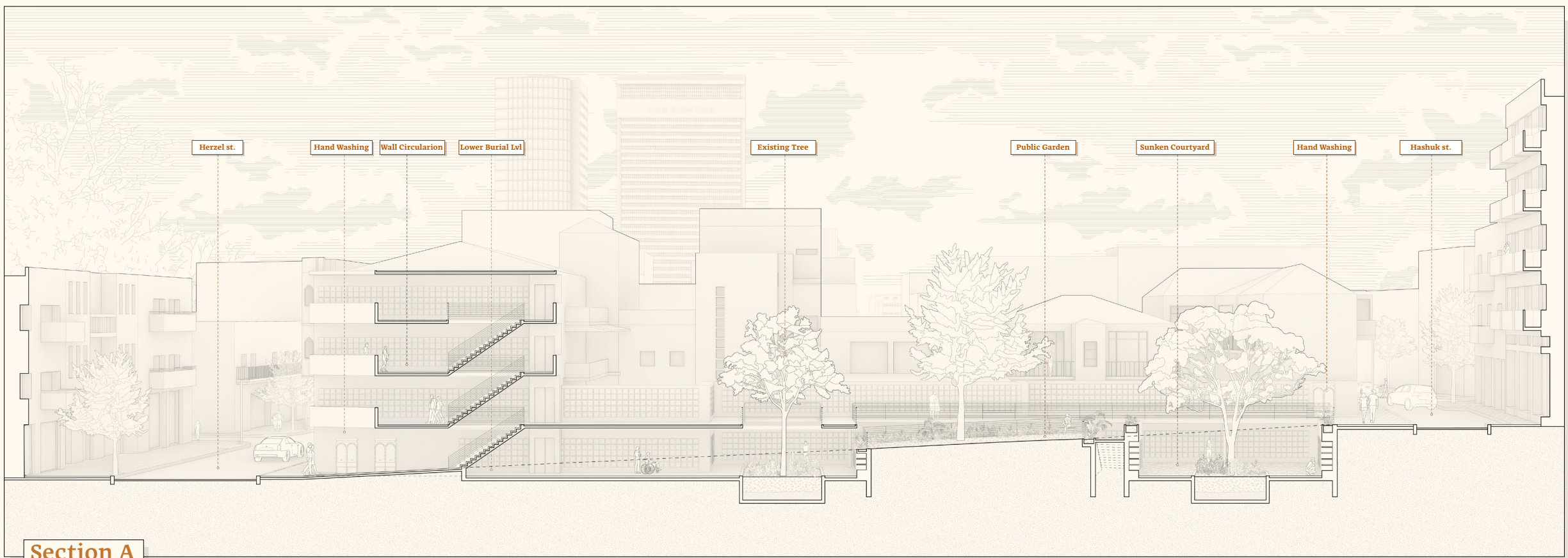
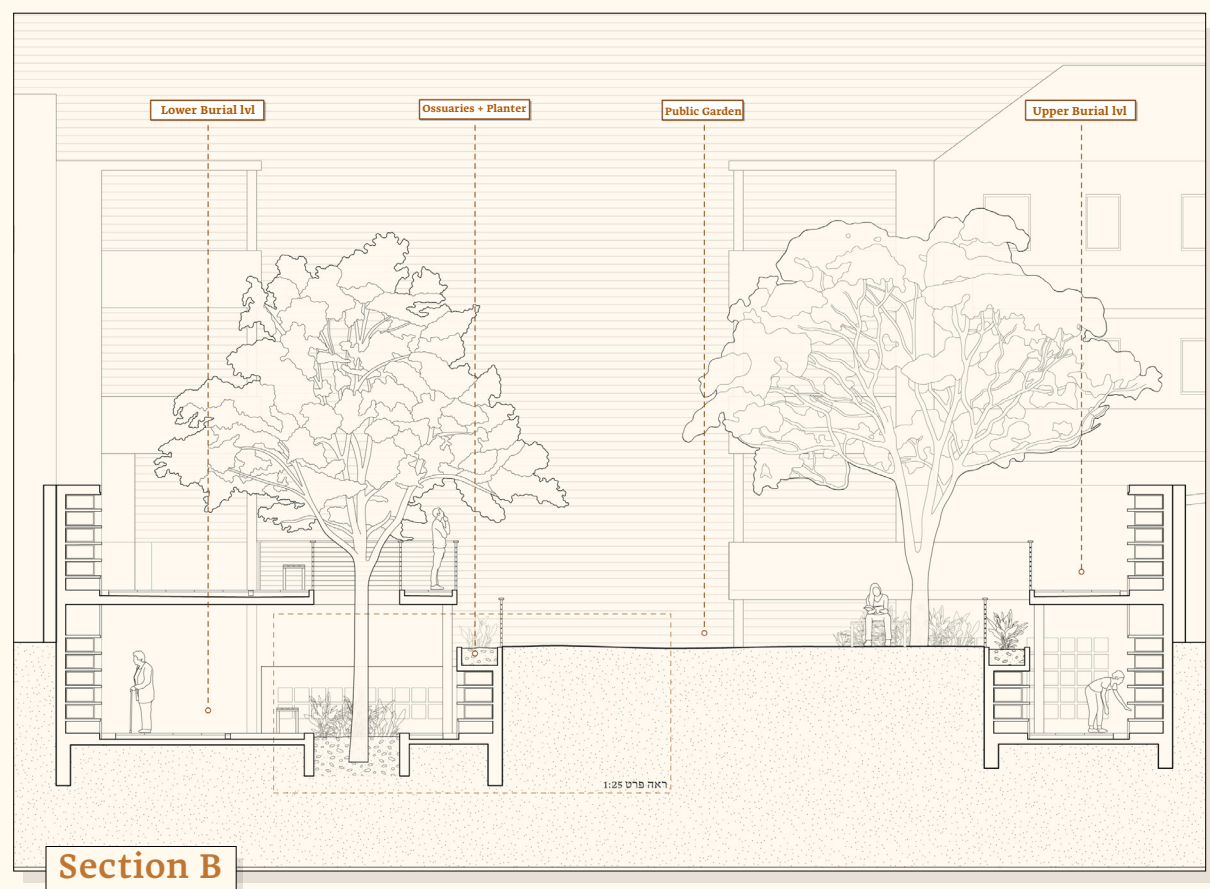
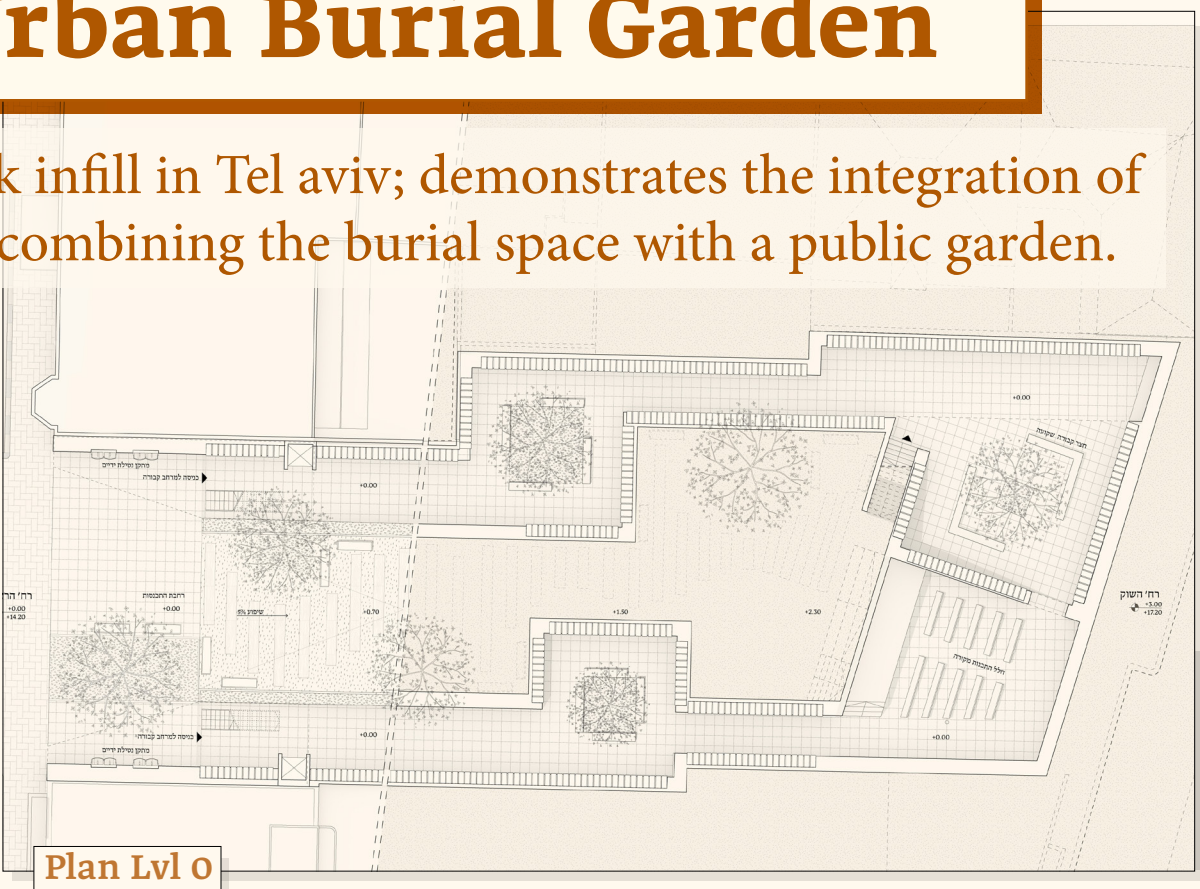
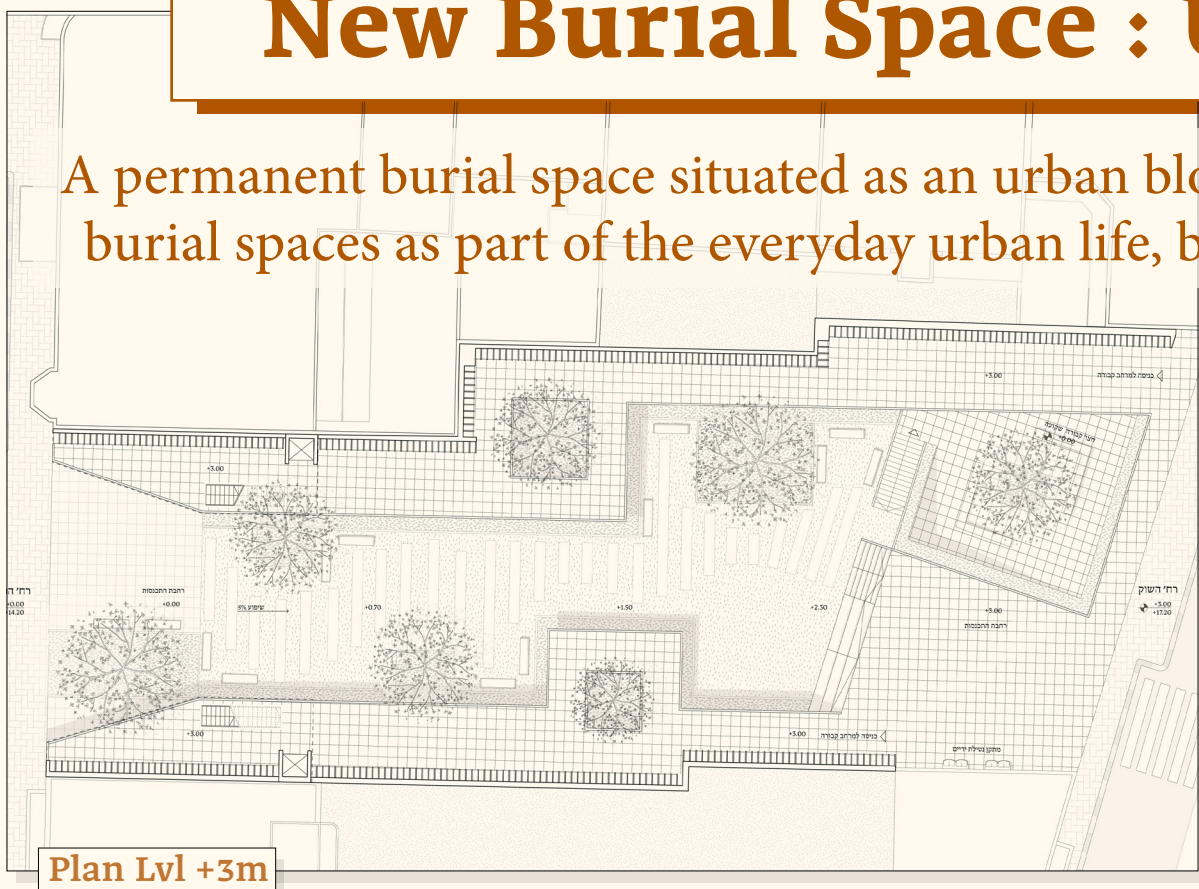
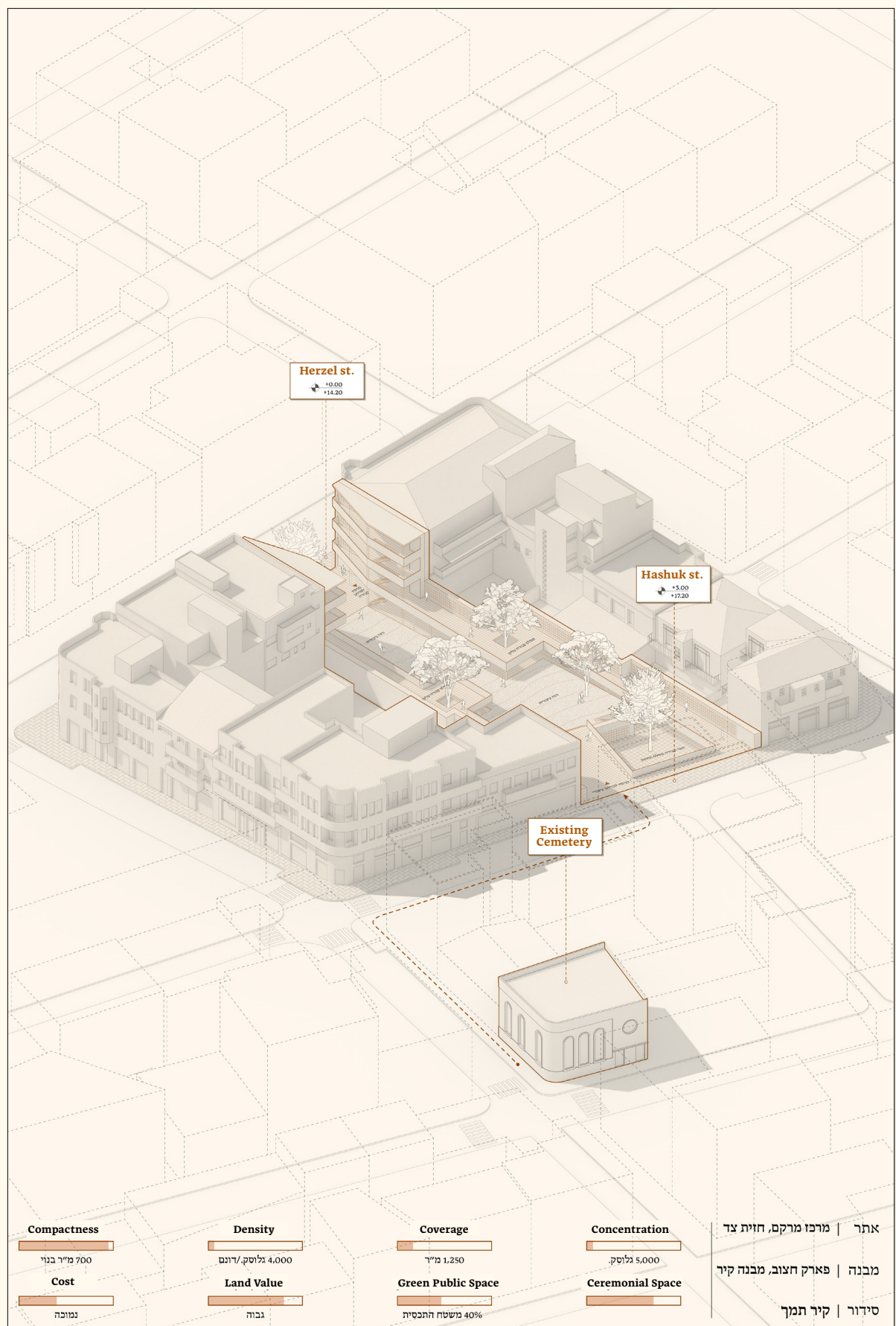

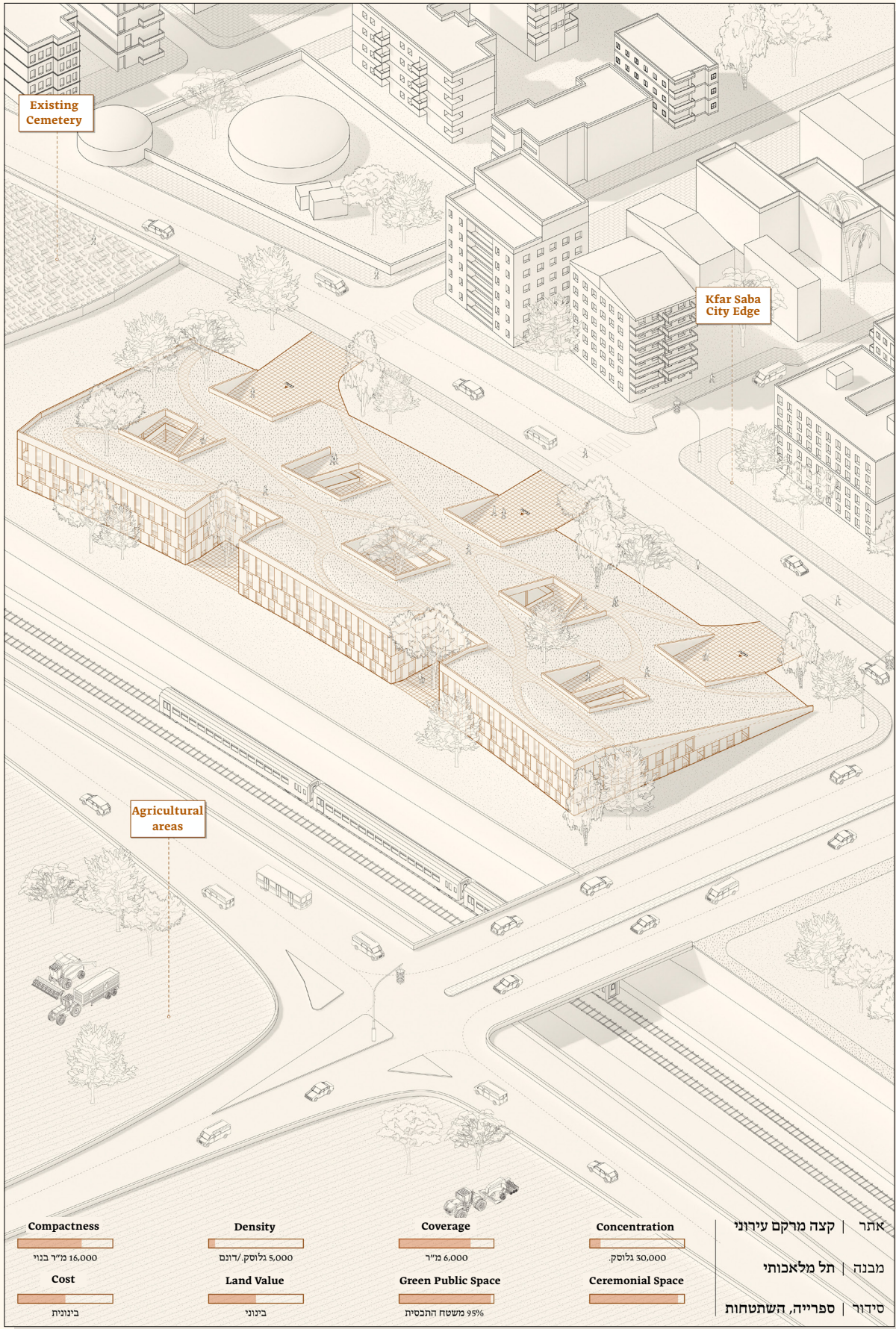

New Burial Space : City-Edge Hill

A permanent burial structure in an empty lot at the edge the city, contains 30,000 ossuaries in high density, and presents a sloped green roof that is intagrated as part of the urban landscape.

